

أسلاك نجد للصناعات الحديدية

ش.م.م



NAJD WIRES INDUSTRY CO.
L.L.C

0 5 3 8 3 8 4 0 4 0

0 5 5 8 7 0 6 1 9 5

info@najdwire.com

KSA, Riyadh . P.O 14321

www.najdwire.com



MANUFACTURING PROGRAMME

- ◆ CHAINLINK FENCE SYSTEM
- ◆ G.I. BARBED WIRE / PVC COATED G.I. BARBED WIRE
- ◆ G.I. CONCERTINA BARBED WIRE
- ◆ PLAYGROUND FENCES
- ◆ POSTS GALVANIZED AND PVC
- ◆ GATES
- ◆ G.I. WIRE
- ◆ PVC COATED G.I. WIRE
- ◆ POWDER COATING SYSTEMS



GAS PIPELINE FENCE AND GATE



PLAYGROUND FENCE AND GATES



FENCE, BARBED WIRE, POST, GATES



FENCE ACCESSORIES, GABIONS



SECURITY FENCE



FENCE AND EMERGENCY GATE

Our Manufacturing Programme :



NAJD WIRE IRON INDUSTRIES MANUFACTURES A WIDE RANGE OF SECURITY SOLUTIONS FOR APPLICATIONS AND HIGH SECURITY OF WELDED WIRES WITH SEVERAL THICKNESSES AND SIZES FOR CUTTING STARTING FROM 2.5 MM ASCENDING TO 6 MM AND WE USE THE BEST AND FINEST TYPES OF ZINC TO PROTECT IRON FROM RUST USING HOT GALVANIZING

THE COMPANY COMBINES YEARS OF MANUFACTURING EXPERIENCE WITH SELECTED RAW MATERIALS, SKILLED TECHNICIANS, KEEN QUALITY ASSURANCE, MODERN MACHINERY, TRIM OPERATIONS AND EFFICIENT MANAGEMENT OF RESOURCES TO PRODUCE PRODUCTS OF GOOD QUALITY AT THE RIGHT PRICES.

THE COMPANY HAS ITS MANUFACTURING FACILITIES AT THE RUSAIL INDUSTRIAL ESTATE, MUSCAT, IN THE SULTANATE OF OMAN. THE LOCATION OFFERS EXCELLENT LEVELS OF COMMUNICATION FACILITIES BY ROAD, SEA AND AIR FOR PHYSICAL MOVEMENT OF MATERIALS, AND RELIABLE COMMUNICATION FACILITIES FOR ENSURING SPEED OF SERVICING CUSTOMERS' NEEDS.

THE COMPANY CONSTANTLY REVIEWS ITS POLICIES OF OPERATION TO BE ABLE TO OFFER THE BEST PRODUCTS AT THE RIGHT PRICES. AFTERALL, THE CUSTOMERS' INTERESTS ARE THE VERY PURPOSE OF THE COMPANY'S BUSINESS.

THE COMPANY OFFERS COMPREHENSIVE ADVISORY SERVICE AT THE TIME OF DESIGN, SPECIFICATION AND EXECUTION STAGES TO ITS CLIENTS AT NO EXTRA OBLIGATION.



HIGH SECURITY FENCE SYSTEM



CORNER POST



DOUBLE LEAF GATE



CHAINLINK FENCE FABRIC (GI FENCE)

Material Galvanised Steel Wire. Zinc coating and strength As per BS4102 in standard range*. Other coatings on enquiry.

Nominal Wire Diameters: 1.6mm, 1.8mm, 2.0mm, 2.5mm, 3.00mm, 3.55mm in standard range. 2.7mm, 3.15mm, 3.4mm, 4.0mm on specific orders. Other diameters can be considered on specific enquiries.

Nominal Mesh Sizes 40mm, 50mm, 65mm, 75mm, 90mm, 25mm in lower wire gauge only.

Nominal Mesh Heights 0.9M to 9.0M in steps of 0.3M. Other special heights can be considered on specific enquiries.

These heights are achieved without helix joints.

Mesh Ends Generally Knuckled. Twisted ends can be provided on specific orders in certain sizes.

Roll Length Generally 10M for heavier gauge wires and 22/20M for lighter gauge wires. Other lengths can be considered on specific enquiries.

*BS4102 grade suitable for use in BS1722 grade fence systems as well as Saudi standard specifications.



PVC COATED G.I. WIRE



G.I. CHAINLINK FENCE FABRIC





P.V.C. COATED G.I. CHAINLINK FENCE FABRIC

Material P.V.C. Coated Galvanised Steel wire, Colour : Green.
Zinc coating & strength As per BS4102 in standard range.

Nominal Wire Diameters G.1. Dia/P.V.C. Dia : Standard Range.
1.6mm/2.5mm, 1.8mm/2.6mm, 2.3mm/3.2mm, 2.5mm/3.55mm, 3.0mm/4.0mm, 3.55mm/4.75mm. Other diameters of enquiry.

Nominal Mesh Sizes 40mm, 50mm, 65mm, 75mm, 90mm, 25mm in lower wire gauge only.

Nominal Mesh Heights : 0.9M to 9.0M in steps of 0.3M. Other special heights can be considered on specific enquiries. These heights are achieved without helix joints.

Mesh Ends : Generally Knuckled. Twisted ends can be provided on special orders in certain sizes.

Roll Length : Generally 10M for heavier gauge wires and 22/20M for lighter gauge wires. Other lengths can be considered on specific enquiries.



PVC COATED GI WIRE



PVC COATED FENCE INSTALLED IN SEAWATER



LONG LIFE HIGH SECURITY FENCE



BUSHOK BARBED WIRES

Material Strand Wires - Galvanised Steel Wire as per BS4102 in standard range.
OR P.V.C. Coated G.I. wire.
Barbs - Galvanised Steel Wire as per BS4102 in standard range
P.V.C. Coated G.I. wire can be provided on specific orders.

Number of Strands : Two

Type of Barb : 4 pointed IOWA type interlocked barb in standard range.
4 pointed GLIDDEN type as well as 2 pointed barbs can be provided on specific enquiries.

Barb spacing : 65mm, 75mm, 85mm, 100mm, 125mm, 150mm.

Wire Diameter : Strand Wire - 2.0mm, 2.5mm, G.I. Wire. 2.6/1.8mm P.V.C. Coated G.I. wire. Barb Wire - 2.0mm G.I. wire. Other diameters and types on enquiry.



RAZOR WIRE



BARBED WIRE

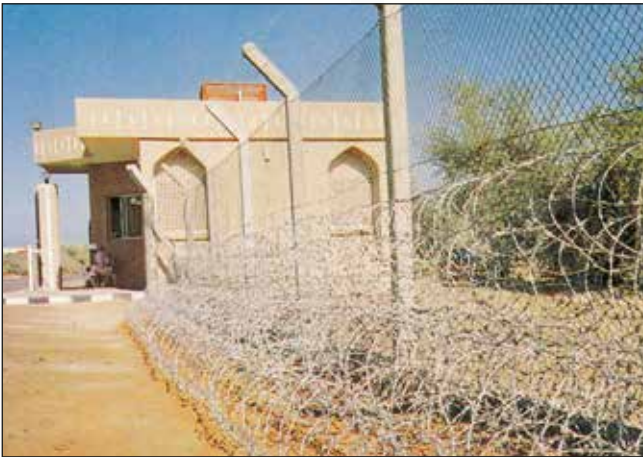



Concertina

Razor wire fence systems are used for high security purposes. Raw materials are produced in 3 types as Galvanize, 430 Quality Stainless and 304 Quality Stainless.

Where to Use

It can be installed in the heights of 45cm, 73cm and 96cm depending on the security level in the application areas. Razor Wires provide an aesthetic stance on the existing fence as well as raise your security to the upper levels.





ACCESSORIES

Chainlink Fencing Company is geared to provide complete fencing systems.

Fencing Accessories form the backbone of a good fencing system. Following is a selection of our standard accessories range from which selections can be made.

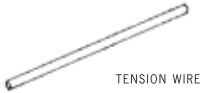

TENSION WIRE

TENSION WIRE : Essential for prestressing the fence. Available in Rolls of G.I. and P.V.C. Coated G.I. wires to BS4102. Size should be selected one size higher than chainlink mesh except in heavy gauges where mesh and Tension wires will be the same.



WIRE STIRRUPS

WIRE STIRRUPS : Required for fastening Tension wires and Barbed wires to post. Available in Rolls of 2.5mm G.I. or 2.5/3.5mm P.V.C. Coated G.I. wires. Mandatory requirement.



WIRE TIES

WIRE TIES : Required for tying fence to tension wires. Available either as rolls of wire or precut lengths in 2.0mm G.I. wire or 1.8/2.6mm P.V.C. Coated G.I. wires. Mandatory requirement.



DROPPER BARS

DROPPER BARS : Made from Galvanised and/or Epoxy coated 25x5 flat bars with holes for fixing with Barbed wire lines. Used as antibunching device on Barbed lines between posts. Optional requirement.



STRETCHER BARS

STRETCHER BARS : Made from Galvanised and/or Epoxy coated 25x5 flat bars with holes for fixing to Strainer posts. Essential for stretching the chainlink fabric taut. Mandatory requirement.



TURNBUCKLES

TURNBUCKLE : Galvanised straining device in M6 and M8 sizes. Required for tensioning Tension and Barbed wires at tension posts. Requirement mandatory but selection optional among alternate straining devices.



EYE BOLT-RING NUT

EYEBOLT-RINGNUT : Galvanised straining device M10 size in lengths of 150mm, 200mm or 250mm with twin nuts and washers. Used for tensioning tension wires and barbed wires at Tension posts. Requirement mandatory but selection optional among alternate straining devices.



WINDERS

SHORT & LONG WINDERS : Galvanised straining devices used for tensioning tension wires at Tension posts. Made from 38x3 flats and M25 binding bolts. Requirement optional.



HAIRPINS

HAIRPIN STAPLES : 7" long Galvanised or P.V.C. Coated Galvanised staple used for anchoring bottom line wire to concrete cill. Requirement optional.



ANGLE CLEATS

ANGLE CLEATS : Used for concrete posts made of Galvanised 50x50 or 75x75 angle 50mm wide, meant for holding Stretcher bars. Requirement mandatory for Concrete posts.

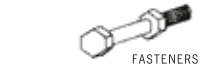

FASTENERS

FASTENERS : Galvanised M8x25, M8x40 fasteners for fixing braces, Stretcher bars and other devices. Requirement mandatory.





STEEL POSTS

Posts are manufactured from appropriate B.S. Grade material. Fabrication is carried out as per established standard practices to Omani Specifications, and BS1722 Specifications.

LINE POSTS

Made from BS4360 and BS4 Standard equal angles of flange size 40x40, 50x50, 65x65, 75x75. OR Galvanised Circular Hollow Sections as per BS1387 Medium Grade or Heavy Grade in outer diameters of 48.3, 60.3, 76.1, 88.9mm.

Selection depends on type and height of fencing.

STRAINER, CORNER AND END POSTS (TENSION POSTS)

Made from Standard equal angles of flange size 50x50, 65x65, 75x75, 100x100 OR Galvanised Circular Hollow Sections of medium or Heavy Grade in outer diameter of 60.3, 76.1, 88.9, 114.3mm.

Selection depends on type and height of fence.

SUPPORT BRACES

Two braces along fence run bolted on each side of Strainer posts made from angles or galvanised circular hollow sections of sizes similar to line posts.

EXTENSION FOR MOUNTING BARBED WIRES

Cranks for Barbed wire fixture is made from the same material as the post and integrally welded to the post during fabrication as per BS1722 recommendations.

PROVISION FOR STRAINING FITTINGS

All Line Posts are predrilled or provided with cleats to take wire stirrups.

All Tension Posts are provided with fastening arrangements to take Stretcher bars, Straining devices such as Eyebolts, Barrel winders etc.

All posts are provided with sufficient length for embedment into the ground.

Angle Posts are spragged at the bottom to holdfast to concrete.

Circular Hollow Sections can be provided with base plates or anchor rods.

All Circular Hollow Sections are provided with integrally welded caps at the top end.

FINISHES

There are 3 Grades of Finished available.

GRADE A : The sections are Galvanised and Epoxy Polyurethane coated to 200 microns in dark green colour.

GRADE B : The sections are Galvanised to BS729.

GRADE C : The sections are Epoxy Polyurethane coated on Wash primed, Abraded bare surfaces in final green colour or Polyester powder coated in dark green or approved colour.

Other colours and finishes can also be considered.

Other types of posts can also be made.



STRAIGHT POST

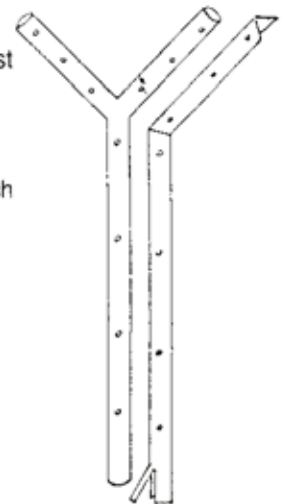

CRANKED POST



PVC posts



Galvanized posts



PLAYGROUND ENCLOSURES

Najd wires Company specialises in Manufacture of Tennis Court enclosures to BS1722 Part 13 and adapted enclosures to other Playgrounds for Football, Hockey, Base ball and such other games where ball retention is important.

Chainlink Fencing Company offers its design advisory services in selection of right kind of enclosure systems with gates and barriers.

Please contact us with your requirements.

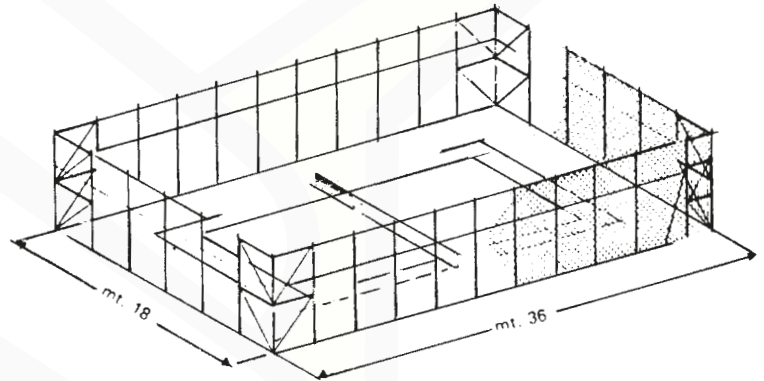



GATES

Najd wires Company manufacturers gates in a very wide range. These include Single Leaf Personnel Gates, Double Leaf Vehicle Access Gates, Sliding Gates, Ornamental Gates, Chainlink Infilled Gates, Fabricated-infill gates etc.

Chainlink infill gates are made to match chainlink fence system. These gates are made to Omani and BS1722 standards.

MATERIALS

MAIN FRAME : 50x50, 65x65, 75x75 angles or 60.3mm, 76.1mm or 88.9mm Medium or Heavy Galvanised Circular Hollow Sections. Sizes depend on requirements.

BRACES : Will be angles 45x45, 50x50 or 65x65 OR 48.3mm, 60.3mm, 76.1mm Medium or Heavy Galvanised Circular Hollow sections.

CHAINLINK INFILL : To match main frame.

ACCESSORIES : Include Hinges, Drop bolts, Draw bolts, Stretcher bars and fasteners.

GATE POSTS : Are made from Heavy duty Circular Hollow Sections of diameter 88.9mm, 114.3mm or 165.1mm.

HEIGHTS & WIDTHS : Will be as per requirement.

Generally Single Leaf Personnel gates will be 1.2M wide in 1.8M, 2.0, 2.4M heights.

Vehicle Access gates will be Double Leaf Gates in 4M, 5M, 6M or 9M width in 1.8M, 2.0M, 2.4M, 2.9M heights.

FINISH : There are 3 Grades of Finsihes available.

GRADE - A : The sections are Galvanised and Epoxy Polyurethane coated to 200 microns.

GRADE - B : The sections are Galvanised to BS729.

GRADE - C : The sections are Epoxy Polyurethane coated on wash primered, abraded bare surfaces in green colour, in 3 coats or Polyester powder coated in green or approved colour.

Any other type, colour or design can also be undertaken.

2.5mm MILD STEEL WIRE MESH
PLASTIC COATED TO 3.5MM DIA.
FIXED TO 25x4 THK. STRETCHER BAR
AND SECURED TO CLEATS WITH M6
DOME HEADED BOLTS

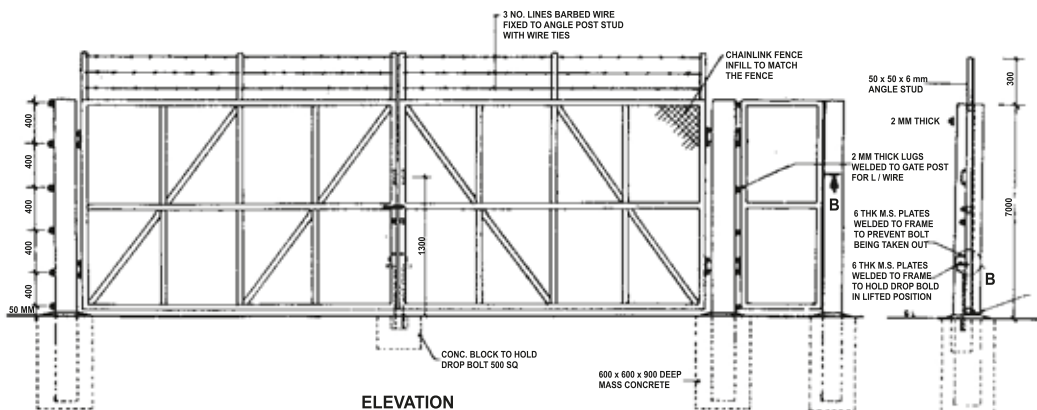
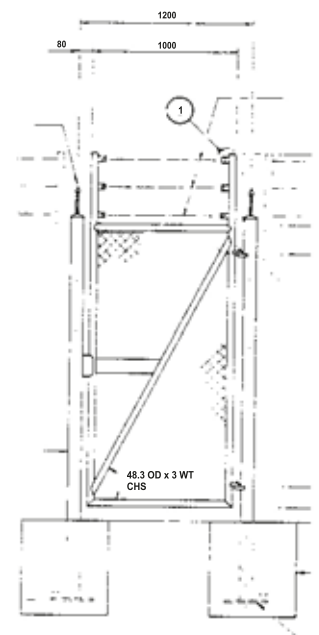
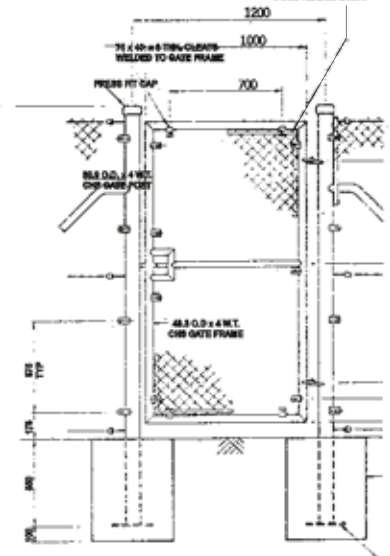



BOUNDARY WALL / FENCE GATES

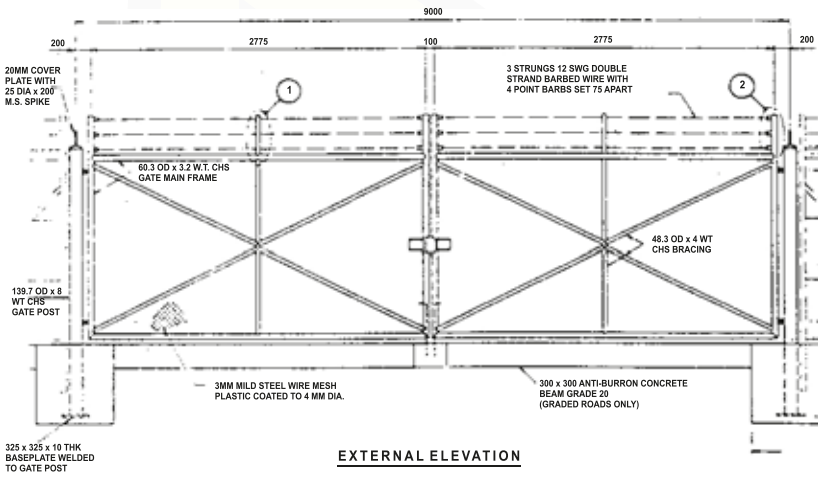



CHAINLINK SYSTEMS

The product range includes line posts, straining posts, corner posts, end posts, struts braces, stretcher bars, tensioning accessories in a wide range both standard and custom-built. Wire Range: In the standard range wires as per BS 4102 are used for manufacture of fence fabrics and wire accessories.

G.I. Wires: 1.6mm, 1.8mm, 2mm, 2.5mm, 2.7mm, 3.0mm, 3.15mm, 3.4mm, 3.55mm, 4mm.

G.I. Wires coated with P.V.C. : 1.62.5/mm, 1.82.6/mm, 2.33.2/mm, 2.5/ 3.55mm, 3.4/mm, 3.554.75/mm.

Mesh Size (nominal) : 40x40, 50x50, 65x65, 75x75, 90x90 100x100mm.

Mesh Heights (nominal) : 0.9 mtrs TO 9.0 mtrs in unspliced helices, with nominal increments of 0.3 Meters.

Mesh Lengths : 10 mtrs to 2022/ mtrs rolls depending on the wire, mesh, mesh height combination to ensure ease of handling.

BARBED WIRE

Two stranded twisted line wires with interlocked, immovable, 4 pointed barbs of IOWA or GLIDDEN type made with G.I. barbs on G.I. strands or P.V.C. coated G.I. strands. Wire diameter : al.: 2mm, 2.5mm Barb spacing : 65, 75, 90, 102, 115, 130, 142 and 150mm. Roll Length : 100 Mtrs, 150 Mtrs, 200 Mtrs, 250 Mtrs.





POSTS AND BRACES

These are made from Angles, Circular Hollow Sections, Square Hollow Section as per BS 1722 Specifications or tailor made to specific requirements and provided with long lasting finishes such as Epoxy Coating or Galvanising or Galvanised and Epoxy coating or polyester Powder Coated.

FENCE ACCESSORIES

Our Fencing Systems are provided with top quality accessories such as Stretcher bars, Straining Turnbuckles, Eyebolt-Ring nut Strainers, Wireties, Wire Stirrups, Tension wires, Hairpin-Staples, Antibunching Separation Droppers, Cleats, Galvanised Fasteners, Base Plates and Cover Plates.

GATES

These are made to BS1722 or custom built to any specification from Angles, Galvanised Circular Hollow Sections, Square Hollow Sections, Provided with sturdy gate posts, dropbolts, draw bolts, hinges with ornamental infills or matching chainlink infills in Single Leaf and Double Leaf combinations to various heights and widths. Finished as required to match with surrounds.





Steel Guard Fence

Meeting the demand for increased visibility and security.

Fabricated from 3mm, 4mm or 6mm wire with apertures of 12.7mm x 1.50mm , making it extremely unlikely to be breached



Welding mesh



Galvanized welded temporary fence panels set on the plates to ensure stability

Features:

Sturdy structured. The welded temporary fence is 360 degree welded between the vertical and horizontal tubes to make sure that it has increased strength.

Attractive appearance. Chain link temporary fence is chain link designed, which has sleek and beautiful appearance compared with welded temporary fence.

Proper galvanized wire and tube fence reduces corrosion, rust for durable use.

The two temporary fences can protect your assets and your security in public road accidents.

Quick and easy to install and can be easily re-located for any emergency.

Panel stabilizers are commonly used to ensure the temporary fence to stand stable against strong wind.

Temporary fence can stand firmly with supporting base.

